

User Manual Book Exhaust Hood

Series

SX 9512 L, SX 7511 L

TABLE OF CONTENTS

FEATURES	3
INSTALLATION	4
Installing the exhaust hood on wall	4
Preparations to be made before installing the exhaust hood	4
Installation of exhaust hood	4
Installation on the bottom part of the kitchen set	5
Installation on the bottom part of the kitchen set	6
Working method	7
HOW TO USE	10
Push button	10
MAINTENANCE	11
TROUBLESHOOTING	13
SPECIFICATION	14

This guide book explains everything you need to know about your new product. Please contact our Customer Care should you need further assistance through www.modena.com.

FEATURES

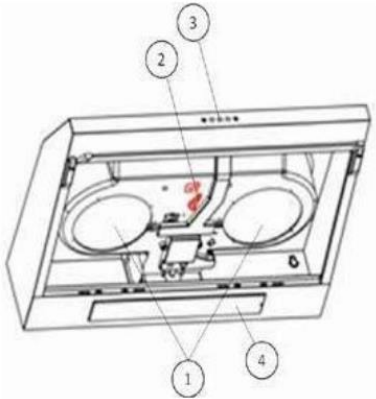

1. Carbon Filter
2. Direction knob
3. Control Panel

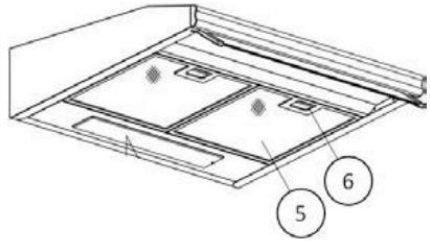

4. Lamp
5. Aluminum Filter
6. Filter locker

INSTALLATION

Exhaust hood is an equipment which sucks smoke and cooking fragrance. With a vent hood, your kitchen will be free from oil particles that may produce bad odor.

1. Check the strength of wall on which the exhaust hood is to be installed. Make sure the wall can sustain the weight / load of the vent hood.
2. The exhaust hood should be installed precisely over the stove at a vertical distance of 65-75 cm from the stove surface.

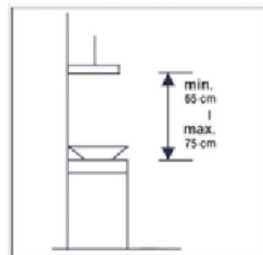

Installing the exhaust hood on wall

Exhaust hood must be installed perpendicularly to prevent the oil from flowing to one side and dripping out of the vent hood.

Preparations to be made before installing the exhaust hood

Remove the exhaust hood from its packaging and put it on an even place (e.g. Tables). Open the grid by sliding the right and left grid locker (6) and then pull it. Remove the spigot / flange (pipe connector) and the hole cover from the plastic bag.

Installation of exhaust hood

Exhaust hood can be installed on the concrete (brick) wall or the bottom part of the kitchen set.

Installing on concrete (brick) wall

1. To install the hood in the wall, drill 4 holes on the wall and the diameter each holes is 8 mm, or according to fisher size at the possible place based on the distance of the center of the back hole of the hood.

CAUTION:

Before drilling, make sure that there's no cable installation, water pipe and installation inside the wall.

2. Insert fisher/nut into the holes.
3. Pair the screw in the 2 above holes and leaving the 1 cm distance from the wall.
4. Install the hood at the wall that already pair 2 screws by hanged on the screws.
5. When the exhaust hood is positioned correctly on the wall, tighten both screws on the upper part.
6. To reinforce the exhaust hood handle on the wall, install the screws on both holes on the bottom part and tighten them.
7. Connect the exhaust system with the spigot / flange if the exhaust hood is to be operated as a ducting / exhaust system.

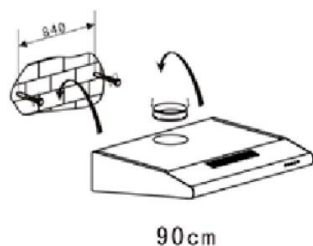
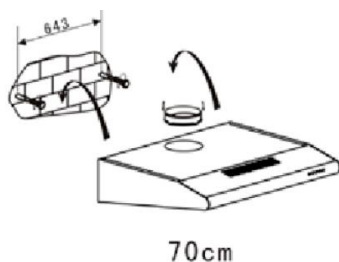
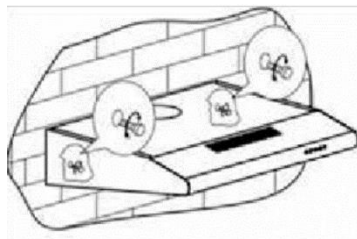

Installation on the bottom part of the kitchen set

1. Put the exhaust hood on the bottom part of the kitchen set in accordance with the planned position.
2. Mark the bottom part of the kitchen set for flexible pipe hole and then create a hole if the exhaust hood is to be operated with ducting / exhaust system.
3. Install the exhaust hood with 4 screws on the prepared position.

4. To reinforce the exhaust hood handle on the kitchen set, install the screws on other holes on the upper part and tighten them.
5. Connect the exhaust system with the spigot / flange if the exhaust hood is to be operated as a ducting / exhaust system

Installation on the bottom part of the kitchen set

1. Put the exhaust hood on the bottom part of the kitchen set in accordance with the planned position.
2. Mark the bottom part of the kitchen set for flexible pipe hole and then create a hole if the exhaust hood is to be operated with ducting / exhaust system.
3. Install the exhaust hood with 4 screws on the prepared position.
4. To reinforce the exhaust hood handle on the kitchen set, install the screws on other holes on the upper part and tighten them.
5. Connect the exhaust system with the spigot / flange if the exhaust hood is to be operated as a ducting / exhaust system.

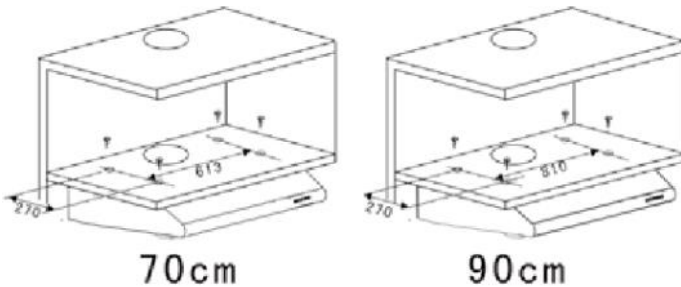

NOTED:

There are two methods to air exchange, it's are covering 'horizontal ventilation' and 'vertical ventilation'. Note the ventilation method when installation. Horizontal ventilation: As shown in the picture. 4A, use a cover to close the outlet at the top, then the air can be streamed from behind. Vertical ventilation: As shown in the picture 4B, use a cover to close the outlet on the back, then air can be streamed from above.

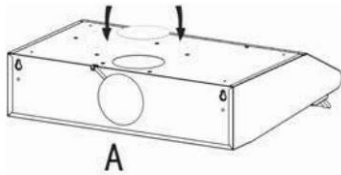

Gbr. 4

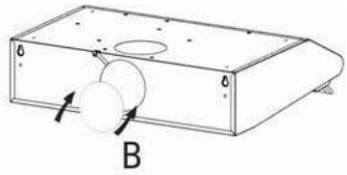

Working method

MODENA hoods have 2 versions of working method, that is:

DUCTING/EXHAUST system

1. In this mode, the exhaust hood operates by sucking the smoke/cooking odor and then discharging it out of the vent.
2. A heat/fire-resistant ducting system is required to discharge smoke/odor out of the vent.
3. To connect the exhaust hood with the discharge duct, use "spigot/flange" is designed with a diameter of 100 or 125 mm.

Several things which require attention in installing the ducting system exhaust hood:

1. Carbon filter must be removed because the cooking odor will be sucked and immediately discharged out of the room.
2. The suction force will be diminished if the exhaust system is too long and there are too many elbows.
3. Do not connect the exhaust system with a chimney or an air duct or hot steam duct.
4. If the exhaust hood is to be installed in a multi-storied building or an apartment, consult with the person in charge of the building / apartment prior to installing the exhaust system.
5. Exhaust hood with ducting system should be used in an open-air room with good air circulation.

RECIRCULATING system:

In this version, the exhaust hood sucks the smoke/cooking odor and filters it through an aluminum filter and carbon filter. The filtered smoke is then recirculated into the room. This system is used if the premise renders it impossible to install a ducting system.

Several things which must be ensured when installing an exhaust hood with recalculating system:

1. Both carbon filter and aluminum filter must be used.
2. The position of both filters must be correct.
3. Holes where air duct is discharged found in the front cabinet of the exhaust hood cannot be closed.

Air ventilation setting

1. At the time of going to apply two circulation systems above please note the following way air vent setting.
2. Outdoor air ventilation (ducting system / exhaust): Turn regulator to position the outdoor (Figure 5A), plug outlet, turn on the suction hood (hood), then the air will flow through the exhaust air duct (dumped out of the room).
3. The air vents in the room (recirculation): Turn regulator to position the indoor (Figure 5B), plug outlet cover, turn on the suction hood (hood), then the air will flow through the inside of the channel (in circulated into the room).

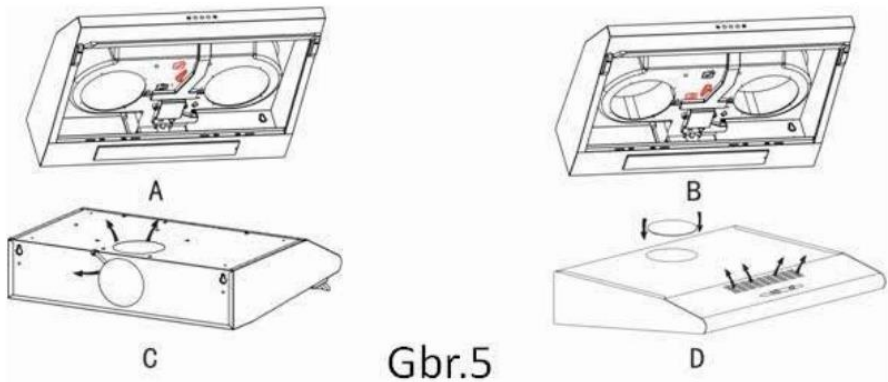

Electricity connection

MODENA Exhaust Hood is designed for 220-volt electricity input, single phase with 50 Hz of frequency. This appliance uses a double-insulated power cord (2 parallel cords) and should not be connected to a grounding wire.

ATTENTION!

Overall installation should be performed by a competent person in the field of electrical or able to do the installation. If you will do the installation yourself, it is recommended that at first consult to the Service Center Modena. Details of the method and frequency of cleaning listed in the "Installation and Maintenance" To separate the equipment from the power source should not attract a wired connection, but the pull of the base / head power cable.

HOW TO USE







- Connect the power cord with an electrical outlet.
- Slide or press the motor speed regulator button and light switch to turn vent hood on or off as shown in the following picture.

NOTES:

Adjust the motor speed of the vent hood according to the thickness of smoke/steam generated by the cooking process.

Push button



-  Turn off the Hood
-  Use motor at low speed
-  Use motor at medium speed
-  Use motor at high speed
-  To switch on or switch off the lamp
-  Will active and the indicator light will turn on when operate the hood motor

ATTENTION:

- Avoid direct contact between the vent hood and open flames from the stove.
- To obtain optimum filtering result, turn off the vent hood 20–30 minutes after having finished cooking.
- Children must be supervised to ensure they do not play with the equipment.
- This hood is designed for household use only.

MAINTENANCE

MODENA Exhaust Hood is specifically designed for long term usage and doesn't require complicated maintenance. However, there are several things you can do to maintain its quality as follows:

Cleaning the cabinet:

To clean the surface of exhaust hood cabinet from sticky oil particles, use cloth / sponge and soap water and dry it. The cabinet should be cleaned after each cooking session.

Cleaning the filter:

Smoke / steam from cooking and oil particles generated by the cooking procedure will be immediately absorbed by the filter and therefore must be cleaned regularly.

Aluminum filter and metal filter:

- For routine usage, clean the aluminum filter once every 10–15 days by soaking the filter in a basin filled with soap warm water during 1 hour and use a soft brush to clean it and then dry the filter thoroughly before returning it to its proper position.
- Aluminum filter can be cleaned using a dishwasher.
- Avoid bending the filter during wash.

Carbon filter:

Carbon filter must be replaced with a new one at least once every 4 months or when the carbon filter is no longer capable of absorbing the cooking odor.

- Remove the power cord from the electrical outlet.
- Open the exhaust hood grid.
- Rotate the carbon filter counterclockwise and remove the carbon filter.
- Install the new carbon filter by putting it in position and rotating it clockwise.

ATTENTION:

Carbon filter cannot be washed and must be replaced with a new one in accordance with the above description. There is a risk of fire if cleaning is not in accordance with the instructions. Condition of carbon filter that have oiling can ease the fire, if there is negligence usage.

TROUBLESHOOTING

Consult the following troubleshooting before contacting our Service Center regarding your exhaust hood:

Problem	Cause	Solution
Exhaust hood malfunctioning	Power cord is not yet connected to the electrical outlet. Electrical outlet does not have electricity current in it.	Connect the power cord to the electrical outlet. Connect the power cord to a properly functioning electrical outlet.
Reduced suction power	Dirty aluminum filter. Dirty carbon filter.	Clean the aluminum filter, dry it and place it back on the vent hood. Replace the carbon filter with a new one.
Motor fan malfunctioning	Broken motor coil.	Contact MODENA Service Center.
Motor stops working after a while	Safety thermal regulator is active.	The vent hood is installed too close to the stove. Air circulation is not optimal. Contact MODENA Service Center.

SPECIFICATION

Model	SX 9512 L	SX 7511 L
Hood type	Slim	Slim
Color of cabinet	Black	Black
Cabinet Material	Metal	Metal
Color of front panel	Black	Black
Motor	2 pieces	1 piece
Lamp	2 bulb	2 bulb
Control panel	Push button	Push button
Ionizer (Germinator)	Available	Available
Kind of filter	Aluminum + Carbon + Vit. C filter	Aluminum + Carbon + Vit. C filter
Motor power	2 x 100 W	100 W
Lamp power	2 x 40 W	2 x 40 W
Dimension (L x W x H) mm	Dimension (L x W x H) mm	700 x 500 x 150
Weight (kg)	8	6.5

Specifications of this appliance may change without notice to improve the quality of the product. Figures in this manual are schematic and may not match your product exactly. Values stated on the machine labels or in the documentation accompanying it are obtained in laboratory in accordance with the relevant standards. Depending on operational and environmental conditions of the appliance, values may vary.

